

STORM™

OnTank / HighPressure OWNER'S MANUAL



WOLVERINE AIRSOFT

www.wolverineairsoft.com

Table of Contents

Important Safety Notices	3
Getting Started	4
Installation / Use / Tournament Lock	5
InGrip Installation / Use	6
Maintenance	8

Don't Forget to Register Your Warranty!

Your STORM Regulator is backed by Wolverine Airsoft's limited warranty. Scan the QR code or visit www.wolverineairsoft.com/warranty to read our full warranty and register your STORM Regulator.



Important Safety Notices

1. High pressure air systems contain air compressed under great pressure and should always be treated with care to avoid serious injury or death. Always be sure that your tank and tank regulator is in good working order before use with the Wolverine Airsoft STORM regulator.

In particular, ensure that all threaded components of the tank regulator are properly torqued to avoid all or part of the tank regulator from unscrewing from the tank during disassembly of the STORM regulator from the tank. Please consult a paintball or airsoft professional tech if you have any questions regarding the safe servicing of your tank.

2. The STORM InGrip regulator is designed for use with a standard paintball style remote line. Traditional HPA lines used for airsoft ARE NOT RATED FOR HIGH PRESSURE between the tank and regulator. Using a standard airsoft airline with the InGrip regulator will result in a rupture of the air line and could cause serious injury.

3. Never leave HPA or CO2 tanks in direct sunlight [including during play], in parked cars, or otherwise submit them to excessive heat. Heat will cause an unsafe rise in pressure in the tank which could lead to serious injury or death.

When using CO2 always be sure to have the tank securely mounted vertically on your body. Allowing the CO2 tank to partially or fully invert will result in liquid CO2 being sucked into the gun which can result in an unsafe spike in pressure/velocity and could damage your Wolverine Airsoft engine.

Getting Started

The Wolverine Airsoft STORM OnTank and STORM InGRIP regulators are intended for use with standard pressure or low pressure paintball HPA tanks. The InGrip regulator can also be used with standard CO2 tanks. Pressure is adjusted by turning the set screw on the front of the regulator using the included 3/32" hex key.

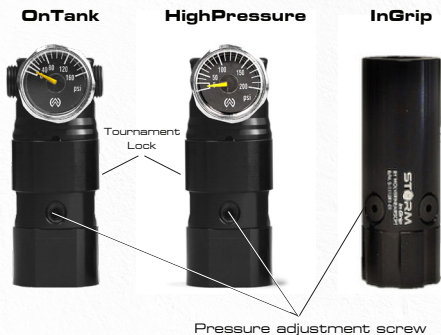

Specifications

Pressure adjustment Range: 40-140 PSIG
[60-180 PSIG for HighPressure]

Input Pressure Range: 300-1000 PSIG

Pressure Adjustment Rate: ~15 PSI/Turn

Recommended Service Time: 100,000 shots or every
6 months

STORM OnTank/HighPressure

Installation

To install the regulator, simply thread the regulator onto the top of your HPA tank. Screw the regulator all the way down until it stops. The final $\frac{1}{2}$ - $\frac{3}{4}$ turn will open valve on the tank regulator to pressurize the system.

Removal

To remove the regulator, unscrew the regulator one complete turn from the tank. Fire the gun to vent any pressure past the regulator. Completely remove the regulator from the tank. Do not partially unscrew the regulator and then re-tighten it without completely removing the regulator from the tank as it may pinch your tank O-ring.

Tuning

Adjust the pressure on the tank by using the included 3/32 hex key to turn the small set screw on the front of the regulator. The regulator is not self-venting so you will need to have the gun connected and fire the gun when adjusting the pressure lower before the gauge will show the new pressure.

Tournament Lock

To engage the tournament lock, slide the black sleeve down to cover the pressure adjustment set screw. Then, simply secure the sleeve with a zip tie.



STORM OnTank/HighPressure

Installation

To install the STORM InGrip regulator remove the stock airline from the back of your Wolverine Airsoft HPA engine using a 5/16" wrench. Install the airline with the 1/4" macro line onto the engine and reinstall engine and gearbox in the gun.

Slide the InGrip base over the tubing up flush against the bottom of the gearbox. Trim the tubing with a sharp pair of scissors 1/8" past the end of the InGrip base. Remove the InGrip base. Install the grip and the InGrip base using the four included M3 screws. If your gearbox only has two threaded holes for attaching the grip, just use two of the included screws.

Screw the regulator into the InGrip base and tighten using the included spanner wrench. The standard ASA to remote adapter included with most remote lines can be screwed directly into the base of the regulator.

Removal

Disconnect the remote line from the gun. Fire the gun until all pressure is vented. Unscrew the ASA to remote adapter from the bottom of the InGrip regulator. You may find a set of channel lock pliers to be helpful in this. Use the included spanner wrench to unscrew the regulator from the InGrip base.

Tuning

In order to change the pressure, the regulator must be removed from the grip of the gun. Adjust the pressure with the regulator removed from the gun. One complete turn of the adjustment screw adjusts the pressure approximately 15psi and 25FPS.

Maintenance

Your STORM regulator is designed to require very little maintenance. However if you feel the regulator is in need of lubrication you can disassemble by removing the three flat head screws from the side of the regulator. Use TechT Gun Sav or another O-ring safe lubricant on all o-rings and reassemble.

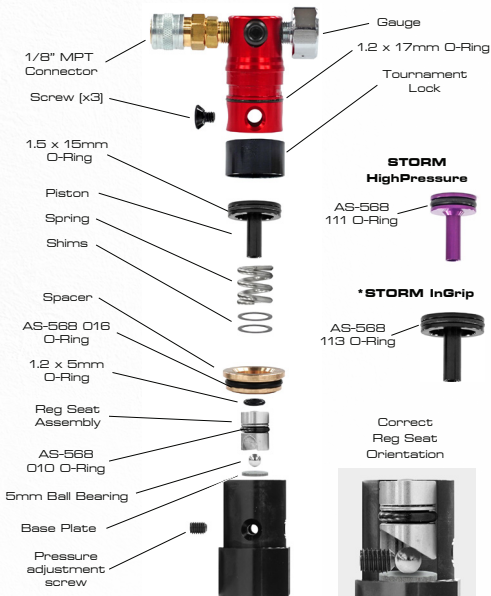

Need professional help?

To find a retailer close to you visit:
www.wolverineairsoft.com/dealers



www.wolverineairsoft.com